

FLEXVERSE®

HYDROPHILIC SWELL BAR

Waterproofing solution for construction cold joints and concrete penetrations

Storage and Installation Guide

Storage



- Prior to use, store FLEXVERSE® swell bars unopened in original packaging, in a cool, dry, and well-ventilated place.
- Under proper storage conditions, the swell bars have a shelf life of about 24 months.

Surface preparation



- Keep the application surface clean, dry, and free from grease, dirt and debris.
- Roughened surfaces are preferred for better gripping.

Application

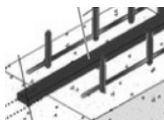

- Secure the swell bar horizontally or vertically on the joint, leaving at least 3-inch concrete coverage on all sides for safe expansion.
- Maintain continuous surface contact using suitable adhesives or mechanical fasteners, to prevent displacement and maximise sealing.
- Concreting should follow promptly. Vibrate concrete systematically to obtain impermeable, void-free concrete, and maximum contact with bar.

Guidelines to prevent and resolve premature swelling



- Hydrophilic swell bars are designed to expand in contact with water. However, premature swelling followed by shrinkage can create voids in concrete. Therefore, it is important to avoid any exposure to water or moisture before concreting.
- If there is a delay in concreting, cover the swell bars to protect from premature swelling due to moisture/rain.
- In case the bars swell prematurely, remove and store affected bars in a dry place, until they shrink back to about 80–90% of original size. These bars can then be reused.
- In the meantime, we recommend to continue work using a fresh lot, to prevent on-site delays.

